

# PACKAGE PICKUP BOILED DOWN TO 4 EASY STEPS

## Instructions for The EGG® Package Delivery System

The EGG is an automated package system designed to make your package pick-up faster and more convenient! When your package is delivered, you will receive an instant notification letting you know that your package has arrived and is being stored securely in The EGG. Just pick up the package at your convenience, without needing on-site staff to assist you.

1



When your package is placed in a secure EGG locker, you're instantly notified via your preferred method of contact (email, voicemail, or text) with a unique PIN-code.

**Please have this code with you when you visit The EGG.**

2

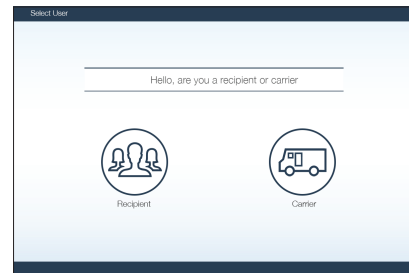

From the main menu screen, choose "Recipient."

3

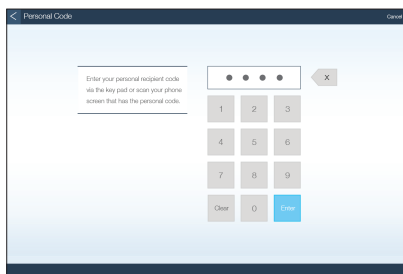

Enter your pin code on the keypad and click "Submit."

4

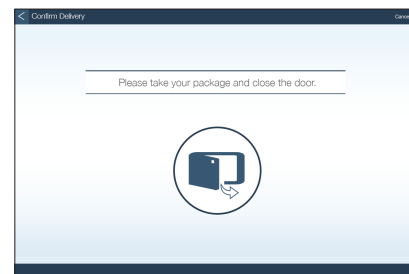

The locker containing your package will automatically open. Remove your package and have a nice day!